

AMORIM SOLUTIONS

IMPACT INSULATION/ISOLATION AUX BRUITS D'IMPACT

13 JULY/JUILLET 2007

MEASUREMENT CONDITIONS/CONDITIONS DE MESURES [417]:

Closed Space/local fermé
Painted Walls/murs peints
Concrete Floor/plancher au béton
Volume = 1087 cu.ft. [30,77 m³]

ASTM E 1007-97 — Standard Test Method for Field Measurement of Tapping Machine Impact Sound Transmission Through Floor-Ceiling Assemblies and Associated Support Structures
ASTM E 989-89 (Reapproved 1994) — Standard Classification for Determination of Impact Insulation Class (IIC)

Floor/Ceiling common surface = 279 sq.ft.
Surface du plancher/plafond commun = 25,9 m²

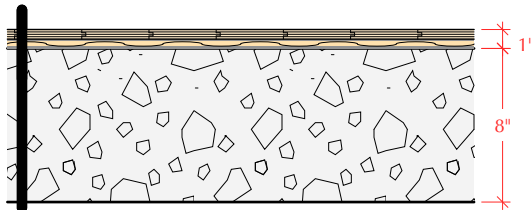

Engineered Wood/bois d'ingénierie 12,7 mm
Polyurethane Wood Flooring Adhesive [DriTac 9200]
Wave Textured Cork/liège texturé 6,0 mm
Polyurethane Wood Flooring Adhesive [DriTac 9200]
Concrete Slab/dalle de béton 8" [200 mm]
Glaze/enduit lisse

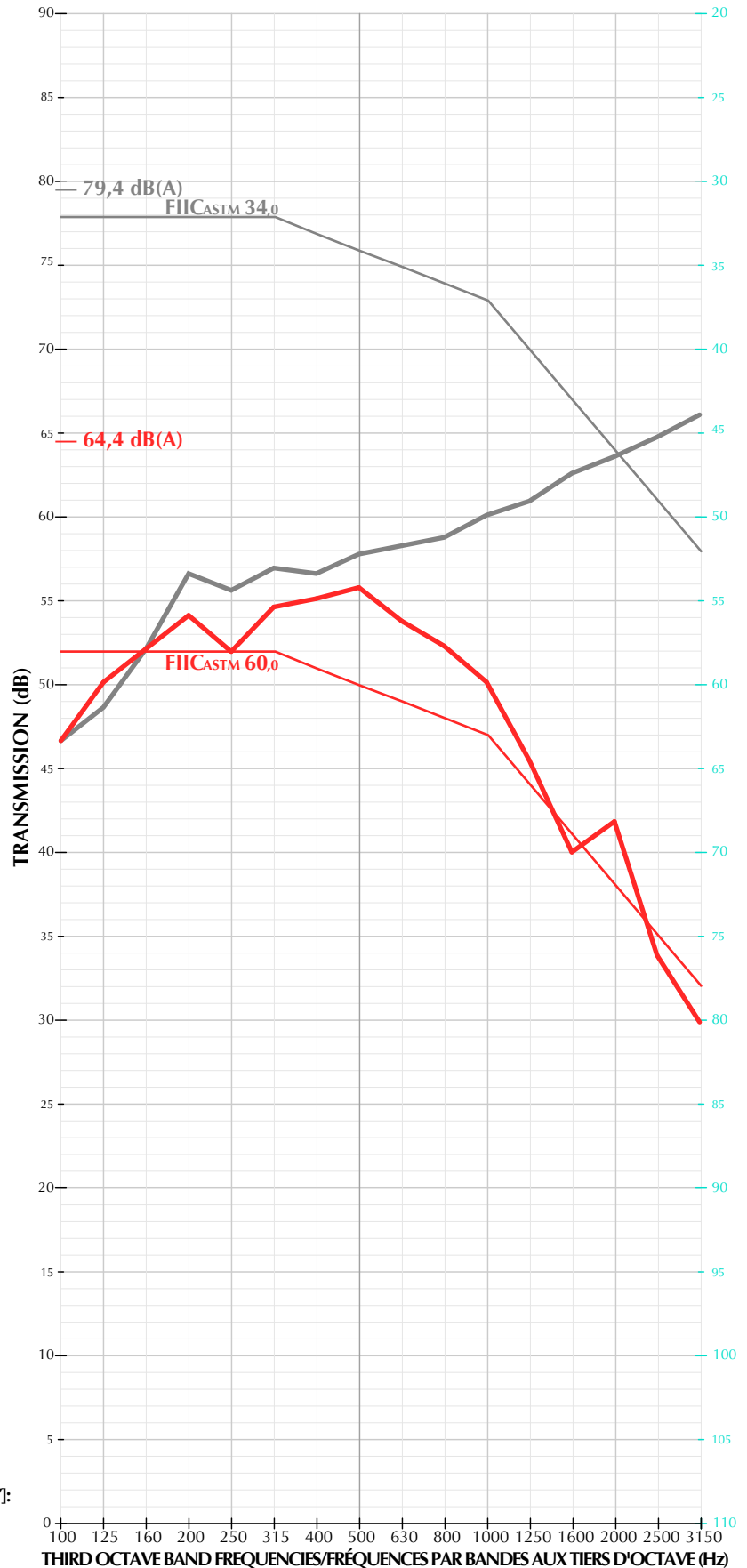

417 TO/VERS 317

FII _{CASTM}	dB(A)	$\Sigma\Delta$	n Δ	Δ_{max}
60	64,4	31,7	9	5,8

417 TO/VERS 317 (CONCRETE/BÉTON)

FII _{CASTM}	dB(A)	$\Sigma\Delta$	n Δ	Δ_{max}
34	79,4	11,8	2	8,0

MEASUREMENT CONDITIONS/CONDITIONS DE MESURES [317]:

Closed Space/local fermé
Painted Walls/murs peints
Concrete Floor/plancher au béton
Volume = 1087 cu.ft. [30,77 m³]

THIRD OCTAVE BAND FREQUENCIES/FRÉQUENCES PAR BANDES AUX TIERS D'OCTAVE (Hz)